

ST50D

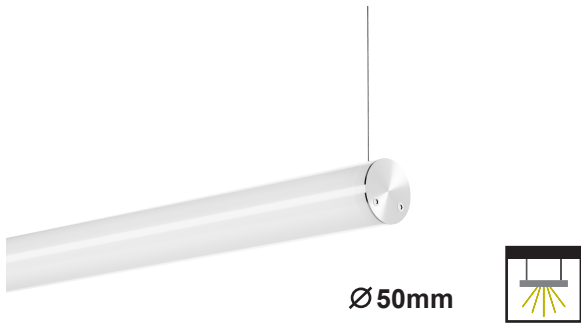

Luminaire tubulaire suspendu horizontalement en polycarbonate..
Émission de lumière vers le bas. Driver intégré.

DESSIN TECHNIQUE .

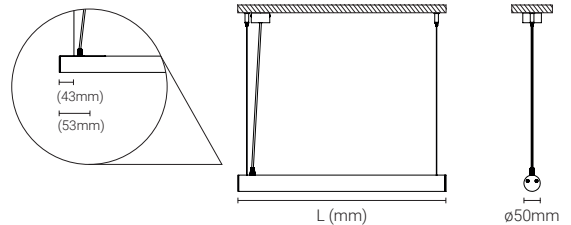

ST50D | LED Module IP43 | IK05

Code	L (mm)	Flow/Power 183lm/W
ST50D.033.xDL	338	1300 lm
ST50D.061.xDL	618	2600 lm
ST50D.089.xDL	898	3900 lm
ST50D.117.xDL	1178	5200 lm
ST50D.145.xDL	1458	6500 lm
ST50D.173.xDL	1738	7800 lm
ST50D.201.xDL	2018	9100 lm
ST50D.229.xDL	2298	10200 lm
ST50D.257.xDL	2578	11700 lm
ST50D.285.xDL	2858	13000 lm

NORMES .

Normes: EN 60598-1:2015, EN 60598-2-1:2012, IEC 60529, EN 62471:2013, EN 55015:2013 + A1:2015, IEC 61000-3-2:2014, EN 61000-3-3:2013, EN 61547:2009, EN 62493:2015

Directives: 2012/19/UE DEEE, 2014/30/UE Compatibilité électromagnétique 2014/35/UE Basse tension, 2011/65/UE - ROHS 2

SYSTÈME ÉLECTRIQUE .



SOURCE D'ALIMENTATION .

DRIVER INTEGRE: 220-240VAC · 50/60Hz

INFORMATIONS LED .

LED 2700K | 3000K | 4000K | 5000K | 6500K
MacAdam 3 · 50.000 h · L90B50 · Ta -20°C a 45°C · CRI 90 · dimmable · $\angle 111^\circ$

COULEURS .

- 1 Blanc .
- 2 Gris .
- 7 Graphite .
- 9 Noir .
- 0 RAL sur demande .

FINITIONS .

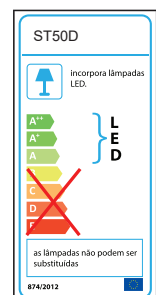

PHOTOMÉTRIE .

Luminous Intensity Distribution Curve - ST50D.061.4FL

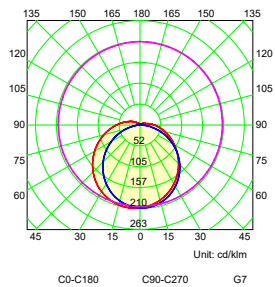

FLEURON.

En saillie

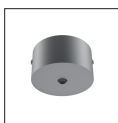

FSR.xxx
Standard

Encastré

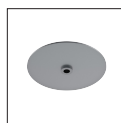

FER.xxx
Option

CABLE ET FILIN DE SUSPENSION EN OPTION



Standard 1,5m

Code	Designation
C02.XXX	Suspension Cable 2 meters
C03.XXX	Suspension Cable 3 meters
C04.XXX	Suspension Cable 4 meters
C05.XXX	Suspension Cable 5 meters

D'autres mesures disponibles sur demande .

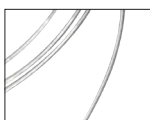

Standard 1,5m

Code	Designation
3A2.XXX	Power Cable 3 Conductors 2 Meters
3A3.XXX	Power Cable 3 Conductors 3 Meters
3A4.XXX	Power Cable 3 Conductors 4 Meters
3A5.XXX	Power Cable 3 Conductors 5 Meters
5A2.XXX	Power Cable 5 Conductors 2 Meters
5A3.XXX	Power Cable 5 Conductors 3 Meters
5A4.XXX	Power Cable 5 Conductors 4 Meters
5A5.XXX	Power Cable 5 Conductors 5 Meters

D'autres mesures disponibles sur demande .